

D-536A

FINAL PLAT

WALNUT WOODS - SECTION THREE
AND A RE-PLAT OF LOTS 4 & 5 WALNUT WOODS SEC. ONE
WHITE RIVER TOWNSHIP, JOHNSON COUNTY, INDIANA

BOUNDARY CURVE
Δ=3°14'14"
R=162.00'
L=9.15'
C.L.=9.15'
T=4.58'
CH.BRK=S 02°40'23" W

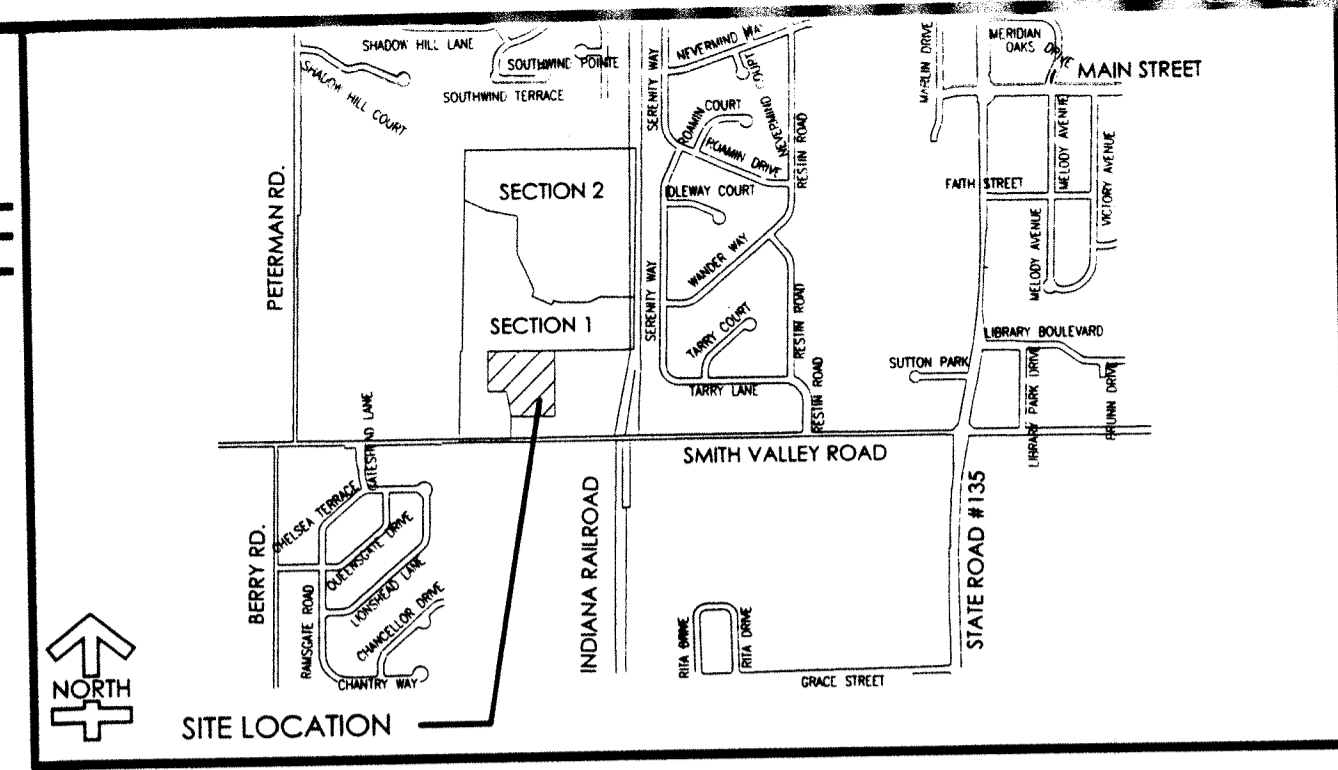

LOCATION MAP



A 5/8" x 36" REBAR SET IN THE CENTERLINE OF WALNUT HILL COURT AT A POINT 245 FEET EAST OF THE INTERSECTION OF WALNUT HILL COURT AND WALNUT HILL DRIVE, SAID 5/8 REBAR BEING SET FLUSH WITH THE GROUND.

WHERE THE SANITARY DRAINAGE SYSTEM CAN BE DISCHARGED INTO THE SEWER OR GRAVITY FLOW, THE LOWEST FLOOR ELEVATION WHERE A PLUMBING FIXTURE OR FLOOR DRAIN IS INSTALLED MUST BE A MINIMUM OF 12 INCHES ABOVE THE TOP OF THE LOWEST DOWNSTREAM OR UPSTREAM MANHOLE CASTING NEAREST TO THE SUBJECT LATERAL CONNECTION, WHERE PART OF THE DRAINAGE SYSTEM CANNOT BE DISCHARGED TO THE SEWER BY GRAVITY FLOW, THIS PART OF THE SYSTEM SHALL BE DISCHARGED INTO A TIGHTLY COVERED AND VENTED SLUMP FROM WHICH THE CONTENTS SHALL BE LIFTED (PUMPED) AND DISCHARGED INTO THE BUILDING GRADUITY DRAINAGE SYSTEM A MINIMUM OF 12 INCHES ABOVE THE TOP OF THE LOWEST DOWNSTREAM OR UPSTREAM MANHOLE CASTING NEAREST TO THE SUBJECT LATERAL CONNECTION.

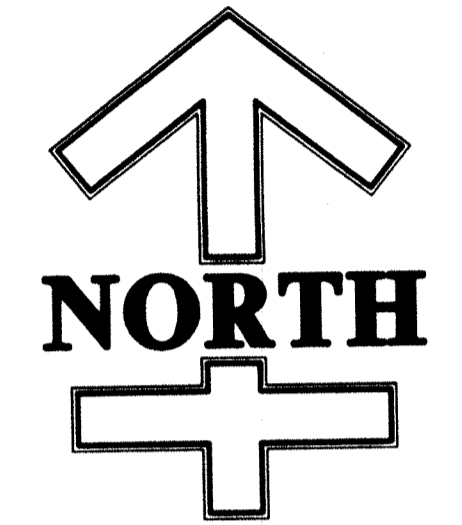

SCALE 1" = 40'

LEGEND :

- 33 LOT NUMBER
- 7200 S.F. LOT SQUARE FOOTAGE
- S.S.D.&U.E. SANITARY SEWER, DRAINAGE AND UTILITY EASEMENT
- D.&U.E. DRAINAGE AND UTILITY EASEMENT
- B.S.L. BUILDING SETBACK LINE
- R/W RIGHT-OF-WAY
- (NR) NON-RADIAL
- 17 LOT CURVE DATA
- CURVE "B" CENTERLINE CURVE DATA
- CENTERLINE MONUMENT (5/8" X 36" IRON PIN)
- CONCRETE MONUMENT (4"x4"x48" W/ IRON PIN)
- △ SECTION CORNER
- M.E.F.P.G. MINIMUM ELEVATION FLOOD PROTECTION GRADE
- HARRISON MONUMENT

| CENTERLINE CURVE DATA TABLE | | | | | | |
|-----------------------------|-----------|---------|---------|---------|----------|---------------|
| CURVE | DELTA | RADIUS | LENGTH | TANGENT | CH. LEN. | CH. BRG. |
| A | 90°00'00" | 100.00' | 157.08' | 100.00' | 141.42' | S 43°56'44" E |
| A-1 | 59°02'10" | 100.00' | 103.04' | 56.62 | 98.54 | S 59°25'39" E |
| A-2 | 30°57'50" | 100.00' | 54.04' | 27.70 | 53.39' | S 14°25'39" E |

| LOT CURVE DATA TABLE | | | | | | |
|----------------------|-----------|---------|--------|---------|----------|---------------|
| CURVE | DELTA | RADIUS | LENGTH | TANGENT | CH. LEN. | CH. BRG. |
| 1 | 90°00'00" | 20.00' | 31.42' | 20.00 | 28.28' | S 46°03'16" W |
| 2 | 60°27'58" | 75.00' | 79.15' | 43.71 | 75.53' | N 58°42'45" W |
| 3 | 72°34'06" | 32.00' | 40.53' | 23.49 | 37.87' | N 07°48'17" E |
| 4 | 28°07'51" | 65.00' | 31.91' | 16.29 | 31.59' | S 30°01'24" W |
| 5 | 64°50'41" | 65.00' | 73.56' | 41.29 | 69.70' | S 16°27'52" E |
| 6 | 62°29'49" | 65.00' | 70.90' | 39.44 | 67.44' | S 80°08'07" E |
| 7 | 62°29'49" | 65.00' | 70.90' | 39.44 | 67.44' | N 37°22'04" E |
| 8 | 37°49'58" | 65.00' | 42.92' | 22.28 | 42.14' | N 12°47'49" W |
| 9 | 65°32'09" | 32.00' | 36.60' | 20.60 | 34.64' | S 01°03'16" W |
| 10 | 18°27'39" | 65.00' | 20.94' | 10.56 | 20.85' | N 24°35'31" E |
| 11 | 63°24'28" | 65.00' | 71.93' | 40.15 | 68.32' | N 16°20'32" W |
| 12 | 54°14'30" | 65.00' | 61.54' | 33.29 | 59.26' | N 75°10'02" W |
| 13 | 7°43'42" | 65.00' | 8.77' | 4.39 | 8.76' | S 73°50'52" W |
| 14 | 37°35'49" | 32.00' | 21.00' | 10.89 | 20.62' | N 88°46'56" E |
| 15 | 16°31'34" | 125.00' | 36.05' | 18.15 | 35.93' | N 80°40'57" W |
| 16 | 90°00'00" | 20.00' | 31.42' | 20.00 | 28.28' | S 43°56'44" E |

